

FOR HEALTHCARE PROFESSIONALS ONLY: This training resource is intended for use by Australian healthcare professionals only (registration and verification may be required) and is designed to comply with Australian law and regulations only. If you are a patient seeking medical advice, please contact your healthcare professional.

Reusable Training Applicator for IMPLANON NXT

Reusable Training Applicator for IMPLANON NXT® (etonogestrel) Subdermal Implant Instructions for Use

FOR TRAINING PURPOSES ONLY.

This guide contains instructions exclusively for the use of the reusable training applicator for the Etonogestrel Implant in connection with implant training program. It does not include all steps necessary to the insertion procedure for the Etonogestrel Implant and is not intended to replace the instructions for insertion of the Etonogestrel Implant.

If you are inserting IMPLANON NXT, stop and refer to the [Product Information for inserting Etonogestrel Implant](#).

This training applicator is a demonstration tool only, and is not intended for human use.

The reusable training applicator is designed to be used multiple times in connection with implant training program. Follow the instructions below to prepare the training applicator before use and to reset the training applicator after each use.

FOR HEALTHCARE PROFESSIONALS ONLY: This training resource is intended for use by Australian healthcare professionals only (registration and verification may be required) and is designed to comply with Australian law and regulations only. If you are a patient seeking medical advice, please contact your healthcare professional.

Parts of the Reusable Training Applicator for Etonogestrel Implant

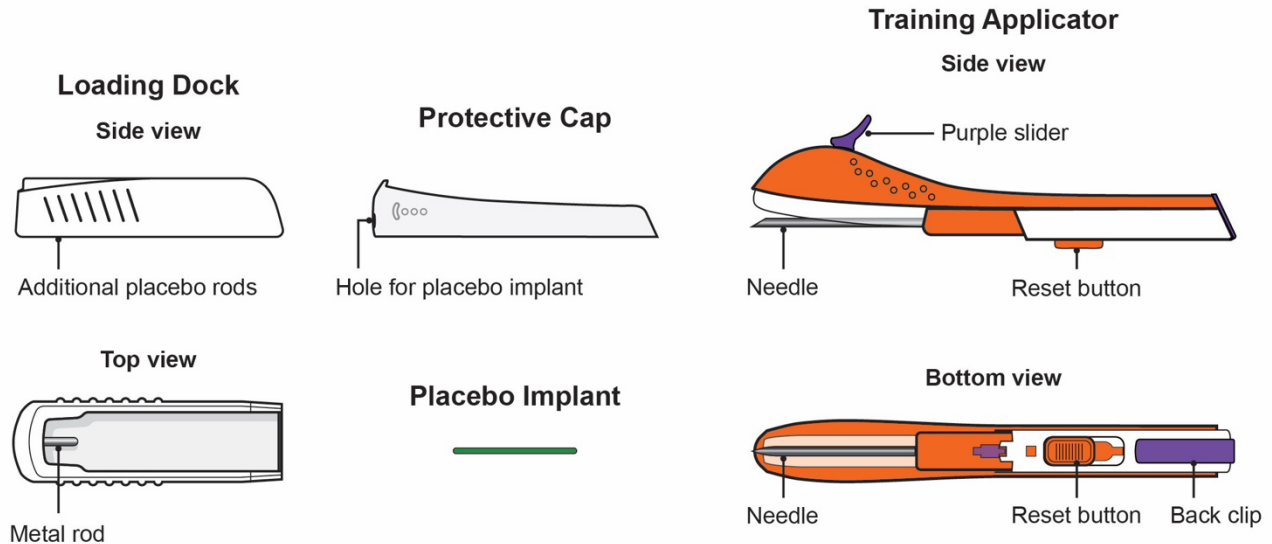

Preparing the Training Applicator for Use

WARNING: Needle is sharp – handle with caution.

Step 1. Remove the Loading Dock

- Hold the applicator just above the needle on the textured surface area.
- Slide the Loading Dock off the applicator away from the needle. To remove the loading dock, slide it horizontally in the direction of the arrow and away from the needle.

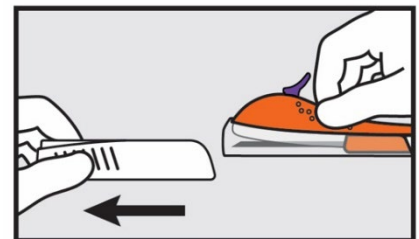

Step 2. Set the Loading Dock Aside

- You will need this later to reset the training applicator

Ensure that:

- The purple slider and reset button are completely forward at the front end of the training applicator, as shown here.
- If not, go to Step 2 in the Resetting the Training Applicator section.

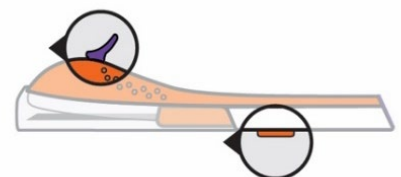

FOR HEALTHCARE PROFESSIONALS ONLY: This training resource is intended for use by Australian healthcare professionals only (registration and verification may be required) and is designed to comply with Australian law and regulations only. If you are a patient seeking medical advice, please contact your healthcare professional.

**The training applicator is now ready for use.
Please follow the instructions provided in the training materials, including the Product Information, to understand how to use the applicator for implant insertion.**

FOR HEALTHCARE PROFESSIONALS ONLY: This training resource is intended for use by Australian healthcare professionals only (registration and verification may be required) and is designed to comply with Australian law and regulations only. If you are a patient seeking medical advice, please contact your healthcare professional.

Resetting the Training Applicator

Before attempting to reset the training applicator, confirm:

- the purple slider is fully back and
- the needle is locked inside the body of the applicator.

- **Note:** DO NOT attempt to replace the protective cap if the needle is exposed.
- If the needle is exposed, pull the purple slider fully back until it stops.

Step 1. Replace the protective cap

- Slide the transparent protective cap on to the training applicator as far as it will go, you will hear a “click” (Figure A).
- **Note:** the training applicator cannot be reset without the protective cap fully in place.

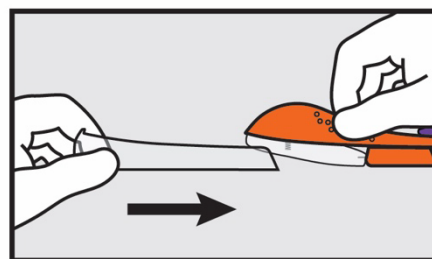

Figure A

Step 2. Slide the reset button toward the back end of the training applicator as far as it will go.

- You will hear a “click” (Figure B).
- The back clip is now flexed downward. This indicates the training applicator is now unlocked and can be reset.

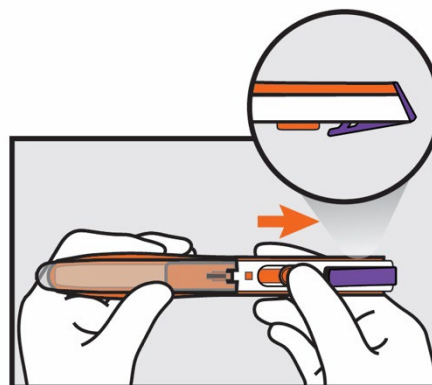

Figure B

Step 3. Push the purple slider toward the needle end until it clicks into place and the back clip closes.

- The applicator is now reset (Figure C).

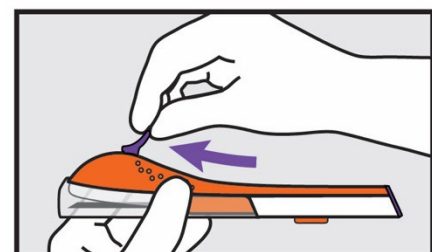

Figure C

FOR HEALTHCARE PROFESSIONALS ONLY: This training resource is intended for use by Australian healthcare professionals only (registration and verification may be required) and is designed to comply with Australian law and regulations only. If you are a patient seeking medical advice, please contact your healthcare professional.

Step 4. Load a placebo implant into the needle

- Insert a placebo (green) implant through the hole in the front of the protective cap and into the lumen of the needle (Figure D).

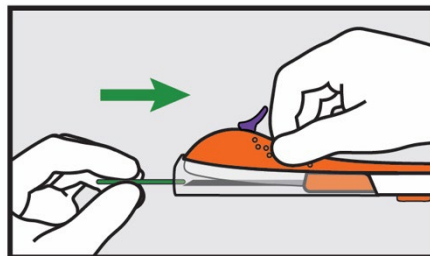

Figure D

Step 5. Finish reloading the placebo implant with the loading dock.

- Slide the training applicator into the loading dock so that the metal rod of the dock is aligned with the hole on the protective cap and push the loading dock all the way forward. The metal rod pushes the placebo rod into the correct position (Figure E).

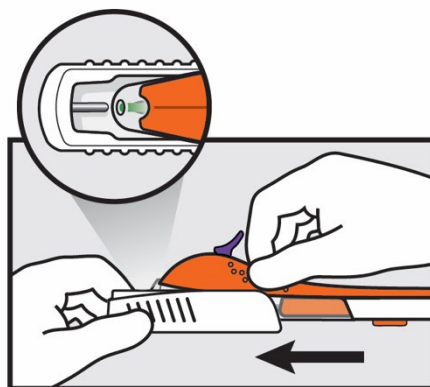

Figure E

The training applicator for Etonogestrel Implant is now ready to be reused.

[Privacy Policy](#) [Terms of Use](#) [Organon Australia Corporate Website](#)

© 2024 Organon group of companies. All rights reserved. ORGANON and the ORGANON Logo are trade marks of the Organon group of companies.

Organon Pharma Pty Ltd, Building A, Level 3, 26 Talavera Rd, Macquarie Park NSW 2113.

Before prescribing Implanon NXT, please review the approved product information, available at: www.organoninfo.com.au/implanonnxtpi

IMPLANON NXT is listed on the PBS as a contraceptive

AU-XPL-110397 | First issued JUNE 2024